

Installation Manual

RADIANCE HEATED TOWEL RAILS



This product is manufactured to international standards:

IEC335-1: 1991
IEC60335-2-43, 1995
AS/NZS3350.1.2002.

IP Rating is IP34

Please read this manual carefully before installation.

This appliance is rated for voltage 200v - 240v.

This appliance has to be connected to earth as it is used in bathrooms.

Colour power connection =

- green/yellow: Earth
- blue: Neutral
- brown: Phase (power)

If installed directly to fixed wiring, a qualified electrician must install this appliance in accordance with local wiring regulations and this instruction manual. A means of disconnection from the supply must be provided. If connected to the supply via a three-pin plug to a fixed socket, the plug must be accessible for disconnection. If the power cord is damaged the complete appliance should be returned to the manufacturer for repair.

Caution: If the appliance is supplied from a cord extension set, or an electrical portable outlet device, it must be positioned so that it is not subject to splashing, or ingress of water.

Warning: In order to avoid a hazard for young children, this appliance must be installed so that the bottom of the appliance is at least 600mm above the floor.

The appliance is not intended for use by young children or infirm persons without supervision. Young children should be supervised to ensure they do not play with the appliance.

Pre-Installation

You have 2 options of power cable connection. You need to choose which option is suitable for your installation – **One:** Standard Outside Power Cable Connection or **Two:** Hidden Power Cable Connection.

Note: Australian Installation Additional Parts:

- 4th Standard Foot
- Short Plastic Hollow Sheath
- 4th Plastic Expander
- 4th Screw Nail
- Glue pack

1. OUTSIDE CABLE CONNECTION > INSTALLATION

(For Australia use the 4 standard bases (No 7) as shown in picture 1 and outside power cable feed in picture 2 below)

(For NZ use the 3 standard bases as above, with the

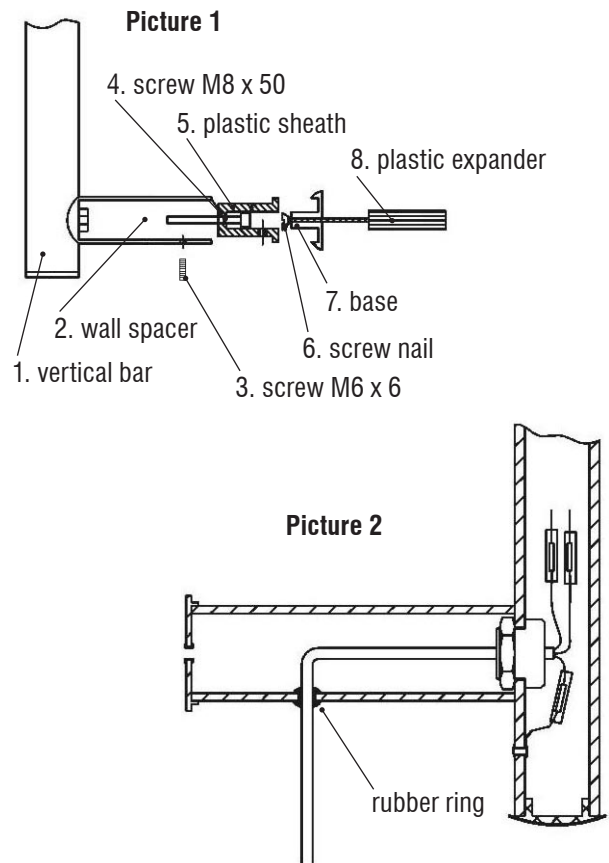

4th base (No 15) as shown in picture 3 with plastic Hollow Sheath (No 14) shown in picture 3)

Installation

Feeding the power cable:

1. Remove the cap away from the hole at the bottom of the wall spacer bracket.

2. Insert the rubber ring in the hole.
3. While holding the rubber ring in place, pull the power cable through the hole, to make the cable available for power connection.
4. Ensure that when selecting the desired position for the heated towel warmer, that you have allowed enough connection cable length to connect to the power supply.
5. **Australia:** Using the 4 wall spacers, (No 2) fix these to the plastic sheaths (No 5) by using screws M6 (No 3) then fix onto the vertical bars using M8 screws (No 4).
6. **New Zealand:** Using the 4 wall spacers (No 2), fix these to the 3 plastic sheaths (No 5), and the 4th leg you will use the Plastic Hollow Sheath (No 14 Picture 3) the same as if you wanted hidden cables, by using screws M6 (No 3), then fix onto the vertical bars using M8 screws (No 4) for the 3 normal spacers and the M4 (No 13) for the 4th leg - The Plastic Hollow Sheath will only be used in either the lower left or right wall spacer depending on which side the cord will come out of.
7. Loosely position the 4 bases (No 7) and (No 15) on to the towel warmer.
8. Place the heated towel warmer on the desired wall position, and mark a "circle" around the circumference of all 4 bases.
9. Using a base as a guide, place it over all 4 marked positions, and mark your drill holes through the base centre hole. **For NZ:** (Note a larger hole of 13mm in diameter will be required in the wall to accommodate the Plastic Hollow Sheath (No 14) for the 4th leg.)
10. Drill the holes and insert the plastic expanders. (No 8) **For NZ:** Use 3 plastic expanders and 1 Plastic Hollow Sheath.
11. Fix the base in position using screw nail (No 6), and then position the heated towel warmer to the bases.
12. Fasten screw M6 (No 3) and (No 10), to hold the heated towel warmer.

2. HIDDEN POWER CABLE CONNECTION > INSTALLATION

Picture 3

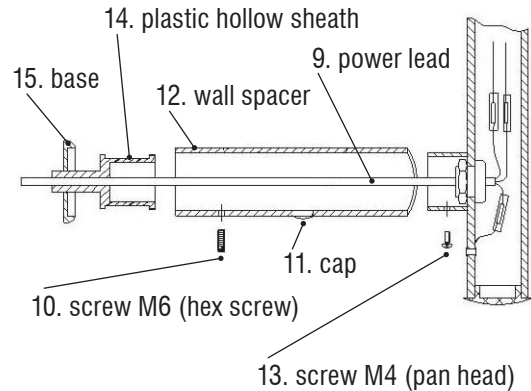

Picture 4

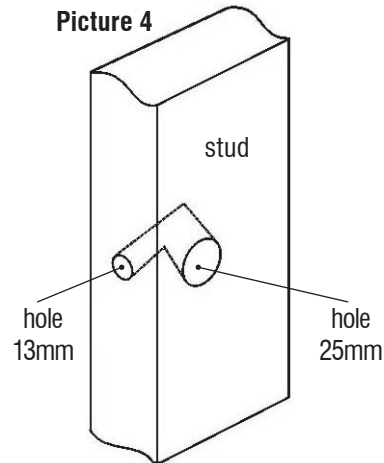

Picture 3 relates to the hidden cable connection, for lower left or right wall spacer, otherwise refer to picture 1 for the other 3 wall spacers.

Pre-Wire Preparation:

1. Drill a 13mm diameter hole into the face of the stud, where the base will sit, to accommodate the cable to be fed through. Drill the hole to a depth of 40mm.
2. Select the side of the stud facing the flush box, which will accommodate the cable feed. Then drill another 25mm diameter hole on that side of the stud at right angles to the first hole, until it meets with the base of the 13mm hole. See above picture 4.

- Place a draw wire from the flush box position, through the 13mm hole, so the power cable can be pulled through exterior cladding at a later date.

Installation:

- Ensure that when selecting the desired position for the heated towel warmer, that you have allowed enough connection cable length to connect to the power supply.
- Remove any exterior cladding around the draw wire to expose the 13mm hole and screw the plastic hollow sheath (No 14) in place, using the cross hole provided.

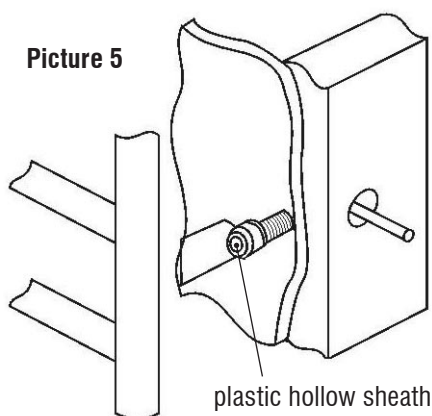

Note: With masonry walls, drill a 14mm diameter hole and fix the thread of the Plastic Hollow Sheath (No 14) in the hole position using epoxy resin, or a suitable builders adhesive. (For AU: Glue is provided) The thread of the hollow sheath should be flush with the outside cladding. (See picture 5.)

- Using the wall spacer (No 12), fix this to the plastic hollow sheath (No 14), by using screw M6 x Hex (No 10), then fix onto the vertical bars by also using an M4 x pan head screw. (No 13)

Note: The Plastic Hollow Sheath (No 14) will only be used in either the lower left, or right wall spacer, to feed the power cable.

- Loosely position the 3 standard bases (No 7) and the one hidden cable base to the towel warmer.
- Place the heated towel warmer on the desired wall position, and mark a "circle" around the circumference of all 4 bases.
- Using a base as a guide, place it over all 4 marked positions, and mark your drill holes through the base centre hole. (NOTE: The drill hole to accommodate the Plastic Hollow Sheath, for the hidden cable connection, needs to = at least 13mm diameter)
- Draw-out the power cable through the hollow plastic sheath and fit to the hidden cable base (No 15). Do not use excessive force.
- Attach the power cable to the draw wire and pull the cable through to the flush box position.
- Now permanently fix all 4 bases to the towel warmer and mount the unit into position.

Important Note: Only use the screws provided so you do not damage the power cord and cause an electrical hazard.

Warranty

For warranty information please see enclosed sheet or websites listed below.

RADIANCE HEATED TOWEL RAILS

Australia

Verve Distribution
6 Todd St, Port Adelaide SA 5015
www.vervedistribution.com.au

verve DISTRIBUTION

New Zealand

The Heating Company
PO BOX 420 Whitianga NZ
www.hotwire.co.nz

